

Invacare® **One Arm Drive by lever**



Yes, you can.



User guide



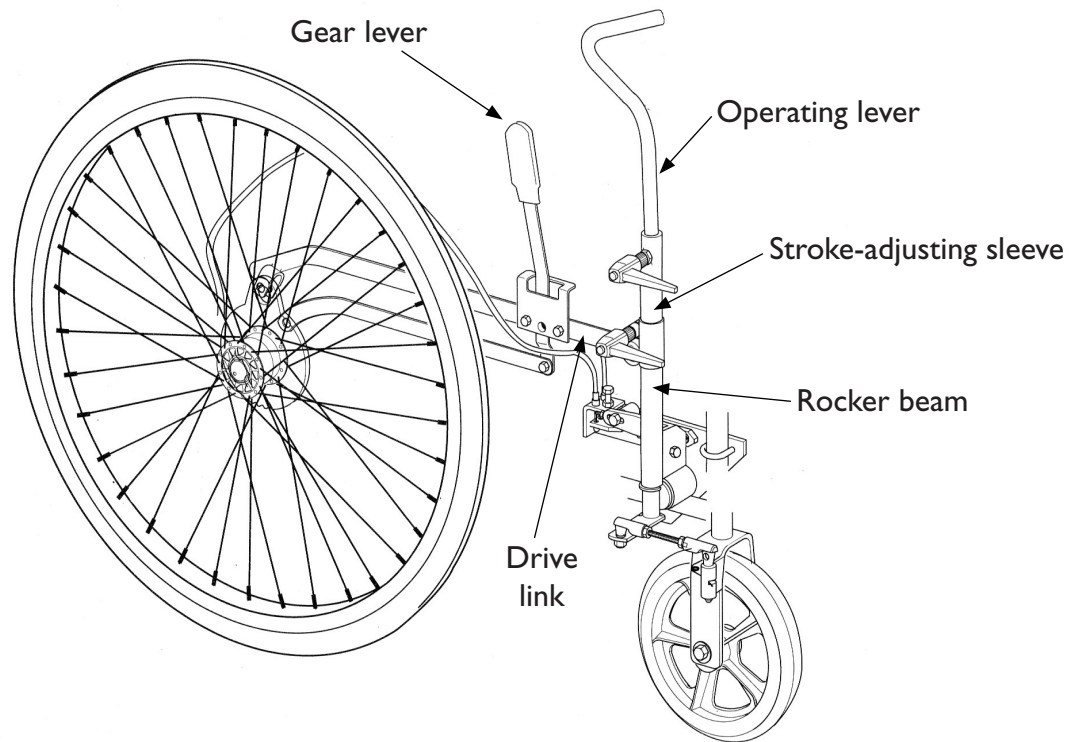

Photo 1 – Diagram of One Arm Drive by lever

I. Description and use

The one arm drive by lever is a device that allows the user to make his/her wheelchair go forward and backward, and to apply the brake using one hand.

The drive may be installed on both the right or left side of the wheelchair.

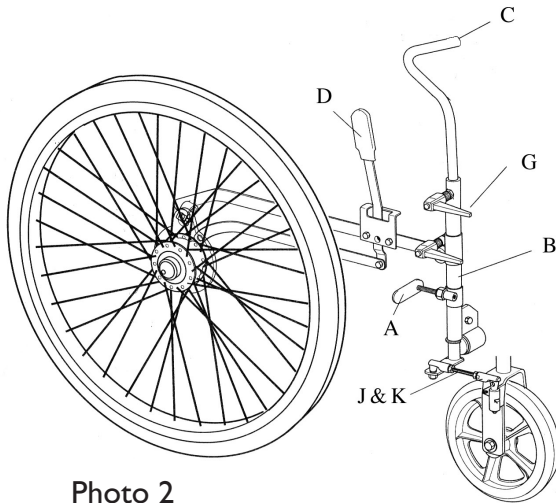

Photo 2

The one arm drive by lever (photo 2) is equipped with a lever brake located opposite the drive as well as with an adjustable brake (A) on the same side as the drive, on the rocker beam (B).

The wheelchair is powered through the forward/backward movement of the operating lever (C).

This operating lever movement allows the wheelchair to drive forward or backward depending on the gear lever position. Its central position is the neutral gear.

Steering is provided by simply turning the operating lever handle (C).

To disengage the wheels, place the gear lever (D) in central position (neutral). (photo 3).

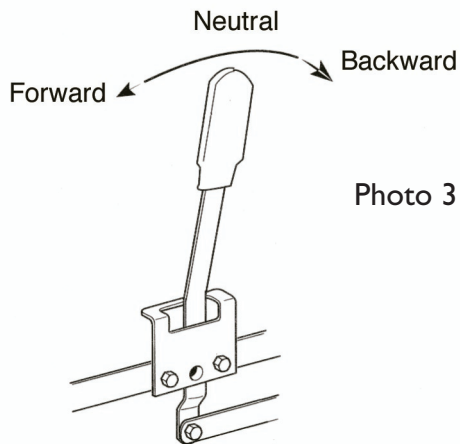

Photo 3

Pulling the operating lever (C) backward provides braking.

To unlock the brakes, place the gear lever (D) in neutral and push the operating lever (C) forward.

2. Adjusting the muscular effort required for driving

Place the stroke-adjusting sleeve (E) of the drive link (F) higher or lower to modify the gear reduction as well as the effort to be applied on the rocker beam (B) that provides the wheelchair drive.

Release the indexable lever (G), slide the clip (H) on the support tube, and fasten the handle in the position that is appropriate for the user's strength. Conduct a few tests to obtain the ideal position. (photo 4)

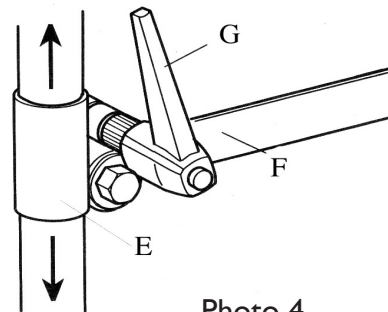

Photo 4

3. Operating lever

Retractable :

To allow the wheelchair to get close to a table, it is possible to dismantle the operating lever (C). Remove it after releasing the indexable lever (I). (photo 5a)

Adjustable :

Three positions provide the height-adjustment of the lever. Unfasten screw (O), slide the lever to the desired position and tightly fasten screw (O). (photo 5b)

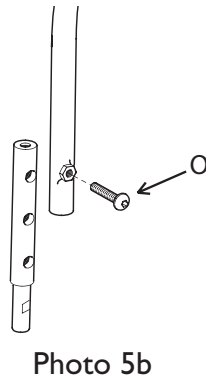
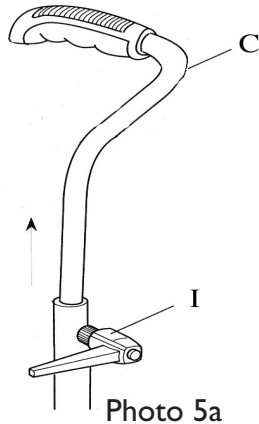

4. Disengaging the steering mechanism

Going up a steep slope or over an obstacle requires the assistance of an attendant. Therefore it is sometimes necessary, for the attendant to move the wheelchair, to disengage the operating rocker beam from the fork in order to release the front directional wheel.

Press the end of the disengaging spring (J) to release the shaft (K). (photo 6)

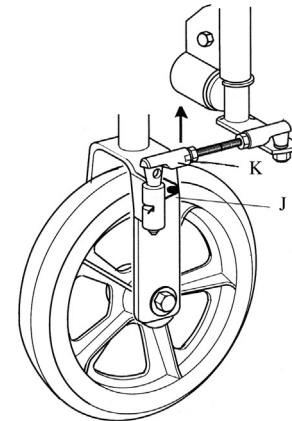

Photo 6

5. Adjusting the brakes

Adjustment on lever side :

Place the lever in forward position; unfasten the locking nuts (L).

Turn the brake shoe (M) on itself to adjust the brake. (photo 7)

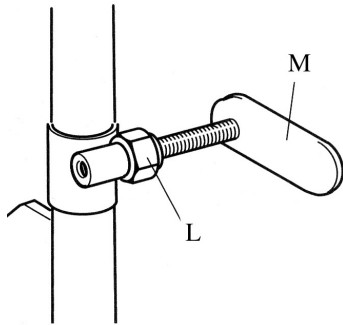

Photo 7

Adjustment opposite the lever :

The brake located opposite the lever is a parking brake.

Push the brake lever forward.

Adjust the brake by unfastening the locking nuts (N) and slide the casing along the tube. (photo 8)

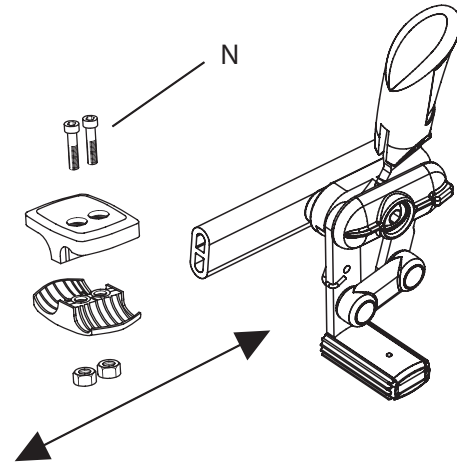

Photo 8

6. Routine maintenance

Weekly :

- Check brake efficiency.
- Check tire inflation in accordance with the specifications indicated on the side of the tires.

Quarterly :

- Lubricate the hinges of the system.
- Make sure that the nuts and screws are tightly fastened.
- Clean chrome surfaces with a dry soft cloth.

Annually :

- Take the wheelchair to your dealer for a general check.



Yes, you can.

Invacare® France Operations SAS Route de Saint Roch - 37230 FONDETTES



Invacare® n.v.

Autobaan 22 8210 Loppem (Brugge) **Belgium & Luxemburg** ☎ +32 (50) 831010 **Fax** +32 (50) 831011

Invacare® AIS

Sdr. Ringvej 39 2605 Brøndby **Danmark** ☎ (kundeservice) +45 - (0) 3690 0000 **Fax** (kundeservice) +45 - (0) 3690 0001

Invacare® Aquatec

Alemannenstraße 10, D-88316 Isny **Deutschland**
☎ +49 (0) 75 62 7 00 0 **Fax** +49 (0) 75 62 7 00 66

European Distributor Organisation

Invacare, KleistsraÙe 49, D-32457 Porta Westfalica **Deutschland**
☎ +49 (0) 31 754 540 **Fax** +49 (0) 57 31 754 541

Invacare® SA

c/Areny s/n Poligon Industrial de Celrà 17460 Celrà (Girona) **España** ☎ +34 - (0) 972 - 49 32 00 **Fax** +34 - (0) 972 - 49 32 20

Invacare® Poirier SAS

Route de St Roch F-37230 Fondettes **France** ☎ +33 - (0) 2 47 62 64 66 **Fax** +33 - (0) 2 47 42 12 24

Invacare® Mecc San s.r.l.

Via dei Pini, 62 I-36016 Thiene (VI) **Italia** ☎ +39 - (0) 445-380059 **Fax** +39 - (0) 445-380034

Invacare® Ireland Ltd

Unit 5 Seatown Business Campus, Seatown Rd, Swords, County Dublin **Ireland** ☎ (353) 1 8107084 **Fax** (353) 1 8107085

Invacare® AS

Grensesvingen 9 0603 Oslo **Norge** ☎ (kundeservice) +47 - 22 57 95 10 **Fax** (kundeservice) +47 - 22 57 95 01

Invacare® PORTUGAL Lda

Rua Senhora de Campanhã 105 4369-001 Porto **Portugal** ☎ +351-225105946 **Fax** +351-225105739

Invacare® AB

Fagerstagatan 9 163 91 Spånga **Sverige** ☎ (kundtjänst) +46 - (0) 8 761 70 90 **Fax** (kundtjänst) +46 - (0) 8 761 81 08

Invacare® B.V.

Celsiusstraat 46 NL-6716 BZ Ede **The Nederland** ☎ +31 - (0) 318 - 69 57 57 **Fax** +31 - (0) 318 - 69 57 58

Invacare® Ltd

South Road Bridgend Mid Glamorgan CF31 3PY **United Kingdom**
☎ (Customer Service) +44 - (0) 1656 - 647 327 **Fax** (Customer Service) +44 - (0) 1656 - 649 016

UK

V1

OADL-G-02 UK
09/2003



Yes, you can.™

Invacare Australia

PO Box 5002

1 Lenton Place

North Rocks NSW 2151 Australia.

email: sales@invacare.com.au

Phone 1800 460 460

Fax: (02) 8839 5311

www.invacare.com.au